

For High Purity Chemicals

Semicon Cupla

SP Type

For semiconductor manufacturing production installation

| | | | | | |
|----------------------------------|------------------------|--------------------------|-------|-----|-----|
| Working pressure | Valve structure | Applicable fluids | | | |
| 0.2 MPa (2 kgf/cm ²) | Two-way shut-off | High purity chemicals | Water | Gas | Air |

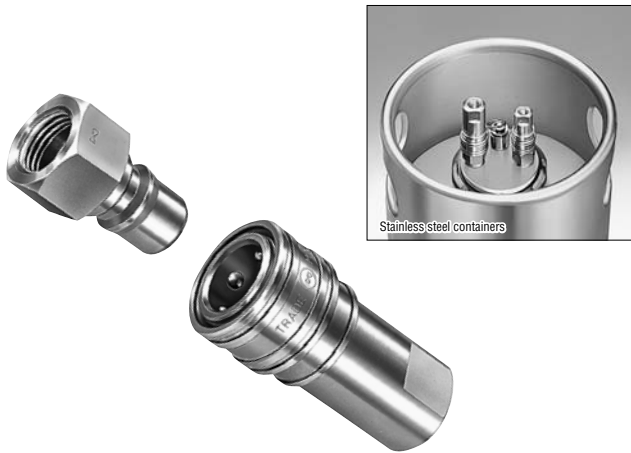

General purpose type with stainless steel body and rubber seal.
Electro-polished body for enhanced corrosion resistance.

- Body and valve springs are stainless steel (SUS304, SUS316). Body is electro-polished for enhanced corrosion resistance.
- Seal materials can be selected to suit your fluid and application, to flexibly comply with your semiconductor production process requirements.
- Abundant size variations allow choice to suit your application and flow rate.
- Each plug comes with a dust cap.

| Specifications | | | | |
|--|---|-------------|---------------------------|-------------------|
| Body material | Electropolished stainless steel (SUS304, 316) | | | |
| Size | 1/8" • 1/4" • 3/8" • 1/2" • 3/4" • 1" | | | |
| Working pressure MPa (kgf/cm ²) | 0.2 (2) | | | |
| Pressure resistance MPa (kgf/cm ²) | 0.3 (3) | | | |
| Seal material Working temperature range | Seal material | Mark | Working temperature range | Remarks |
| | Fluoro rubber | FKM (X-100) | 0°C~+50°C | Standard material |
| | Ethylene-propylene rubber | EPDM (EPT) | 0°C~+50°C | Standard material |
| | Perfluoroelastomer | P | 0°C~+50°C | Standard material |
| | Kalrez | KL | 0°C~+50°C | Standard material |

| Min. Cross-Sectional Area (mm ²) | | | | | | |
|--|-----|-----|-----|-----|-----|-----|
| Model | 1SP | 2SP | 3SP | 4SP | 6SP | 8SP |
| Min. Cross-Sectional Area | 13 | 17 | 48 | 64 | 83 | 192 |

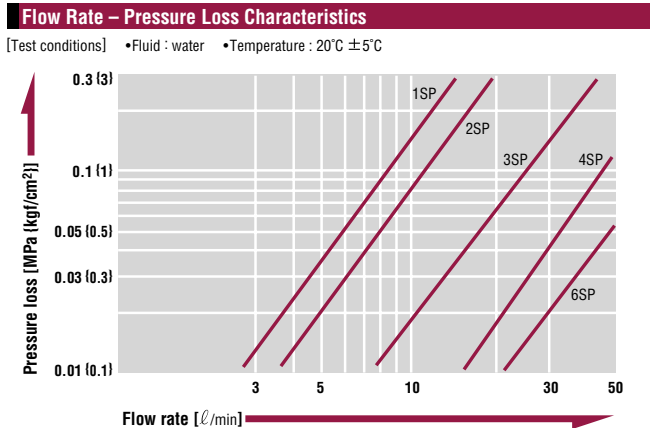

Models and Dimensions

| Plug | Female thread | Container capacity | Mass (g) | Dimensions (mm) | | | |
|------------|---------------|--------------------|----------|-----------------|---------|-------------|------------------|
| | | | | Lp | C | Hp(WAF) | T(Female thread) |
| 1P-304 | for 10ℓ~20ℓ | 19 | 29 | 19 | *Hex.14 | Rc 1/8 | |
| 1P-304-UNS | for 10ℓ~20ℓ | 34 | 33 | 19 | Hex.21 | 19/32-18UNS | |
| 1P-304-NPT | for 10ℓ~20ℓ | 19 | 29 | 19 | *Hex.14 | NPT 1/8 | |
| 2P-304 | for 10ℓ~20ℓ | 35 | 36 | 22 | *Hex.17 | Rc 1/4 | |
| 2P-304-UNS | for 10ℓ~20ℓ | 41 | 36 | 22 | Hex.21 | 19/32-18UNS | |
| 2P-304-NPT | for 10ℓ~20ℓ | 35 | 36 | 22 | *Hex.17 | NPT 1/4 | |
| 3P-304 | for 100ℓ~200ℓ | 60 | 40 | 25 | *Hex.21 | Rc 3/8 | |
| 4P-304 | for 100ℓ~200ℓ | 115 | 44 | 28 | *Hex.29 | Rc 1/2 | |
| 6P-304 | for 100ℓ~200ℓ | 216 | 52 | 36 | *Hex.35 | Rc 3/4 | |
| 8P-304 | for 100ℓ~200ℓ | 352 | 62 | 40 | *Hex.41 | Rc 1 | |

* May have 2 spanner flat design instead of hex nut depending on packing material.
 * The appearance of SUS304 and 316 bodies are different. (Above shown is that of SUS304.)

WAF : WAF stands for width across flats.

| Socket | Female thread | Container capacity | Mass (g) | Dimensions (mm) | | |
|------------|---------------|--------------------|----------|-----------------|--------------|---------|
| | | | | Ls | øD | Hs(WAF) |
| 1S-304 | for 10ℓ~20ℓ | 82 | 48 | 24 | Two flats 14 | Rc 1/8 |
| 1S-304-NPT | for 10ℓ~20ℓ | 84 | 48 | 24 | Two flats 14 | NPT 1/8 |
| 2S-304 | for 10ℓ~20ℓ | 138 | 58 | 28 | Two flats 19 | Rc 1/4 |
| 2S-304-NPT | for 10ℓ~20ℓ | 138 | 58 | 28 | Two flats 19 | NPT 1/4 |
| 3S-304 | for 100ℓ~200ℓ | 204 | 65 | 35 | Two flats 21 | Rc 3/8 |
| 4S-304 | for 100ℓ~200ℓ | 424 | 72 | 45 | Two flats 29 | Rc 1/2 |
| 6S-304 | for 100ℓ~200ℓ | 708 | 88 | 55 | Two flats 35 | Rc 3/4 |
| 8S-304 | for 100ℓ~200ℓ | 1081 | 102 | 65 | Two flats 41 | Rc 1 |

Before use, please be sure to read "Safety Guide" described at the end of this book and "Instruction Sheet" that comes with the products.