



Multiple port systems for air/water

# Multi Cupla

## MAM-A Type

Working pressure  
  
 1.0 MPa  
 (10 kgf/cm<sup>2</sup>)

Valve structure  
  
 Two-way shut-off

Applicable fluids  
  
 Air Water

**Simultaneously connects several ports securely in one operation! Greatly reduces changeover time in multiple port replacement.**

- Two-stage lever operation prevents Cupla from accidental dropping due to sudden detachment.
- Comes with lock mechanism to prevent accidental disconnection
- Large flow equivalent to that of SP Cupla Type A
- Two kinds of plates are available for each size.
- Automatic shut-off valves in both socket and plug prevent fluid spill out on disconnection.

MAM-A-2P12 x MAM-A-2S12  
 (12 port types)

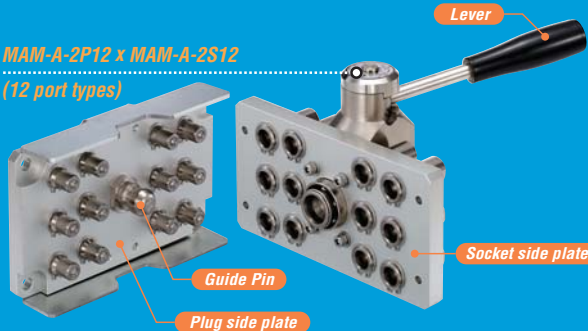

MAM-A-3P12 x MAM-A-3S12  
 (12 port types)

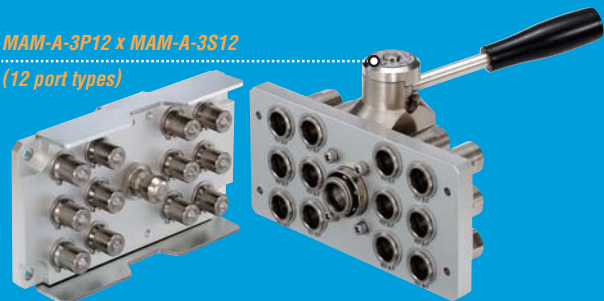

MAM-A-4P8 x MAM-A-4S8  
 (8 port types)

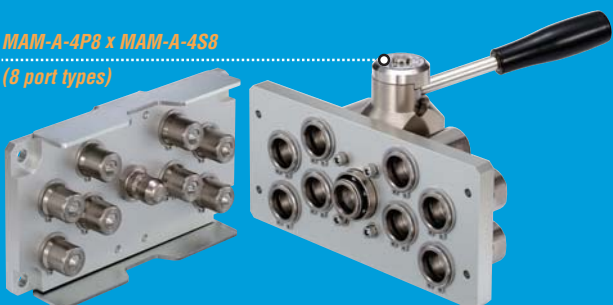

### Specifications

Model	Plug	MAM-A-2P6	MAM-A-2P12	MAM-A-3P6	MAM-A-3P12	MAM-A-4P4	MAM-A-4P8
	Socket	MAM-A-2S6	MAM-A-2S12	MAM-A-3S6	MAM-A-3S12	MAM-A-4S4	MAM-A-4S8
Number of ports		6	12	6	12	4	8
Size		1/4"		3/8"		1/2"	
Body material		Cupla: Brass (Nickel-plated)				Plate: Aluminum alloy	
		Locking unit: Steel (with Autocatalytic Nickel-Phosphorus coating)					
Working pressure MPa (kgf/cm <sup>2</sup> )		1.0 (10)					
Pressure resistance MPa (kgf/cm <sup>2</sup> )		1.5 (15)					
Ambient temperature range		0°C~+60°C					
Sealing material	Sealing material	Fluoro rubber		Mark		Working temperature range	
Working temperature range				FKM (X-100)		-20°C~+180°C	

### Max. Tightening Torque

N·m (kgf·cm)

Size	1/4"	3/8"	1/2"
Torque	9 (92)	12 (122)	30 (306)

### Interchangeability

No connection is possible between plates with different number of ports.

### Min. Cross-Sectional Area per Port

(mm<sup>2</sup>)

Model	2SP	3SP	4SP
Min. Cross-Sectional Area	26	51	73

### Suitability for Vacuum

Not suitable for vacuum applications in either connected or disconnected condition.

### Admixture of Air on Connection

(mℓ)

Model	2SP	3SP	4SP
Volume of air	1.1	2.7	3.9

### Spill out on Disconnection per Port

(mℓ)

Model	2SP	3SP	4SP
Spill out volume	0.8	2.1	3.4

### Flow Rate - Pressure Loss Characteristics

Per port of Cupla

[Test conditions] • Fluid : Water • Temperature : 25°C ± 5°C

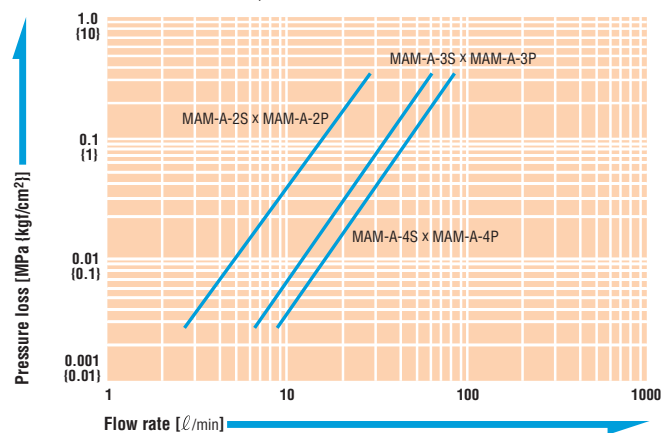

### Denotation of Model

**MAM-A** -         

4 : 4 ports / 6 : 6 ports  
 8 : 8 ports / 12 : 12 ports

S : Socket / P : Plug

Size  
 2 : 1/4" / 3 : 3/8" / 4 : 1/2"

● Before use, please be sure to read "Safety Guide" described at the end of this book and "Instruction Sheet" that comes with the products.

Made-to-order Multi Cuplas are available on request, such as a combination of different sizes on the flange plate.

Models and Dimensions

Model **MAM-A-2P6 × MAM-A-2S6** (6 ports on smaller plate)

• Application: R1/4 Mass: 1100g (Plug), 2150g (Socket)

Plug: Model **MAM-A-2P6**

Socket: Model **MAM-A-2S6**

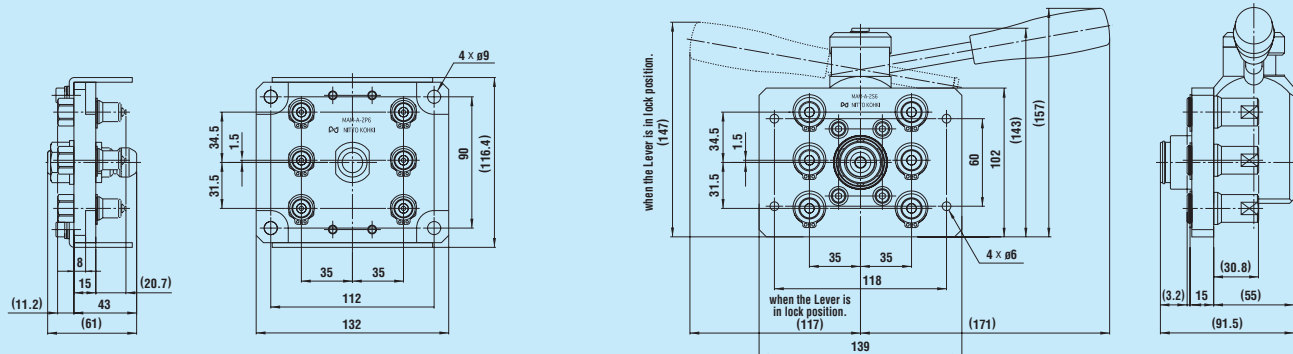

Dimensions (mm)

Model **MAM-A-2P12 × MAM-A-2S12** (12 ports on larger plate)

• Application: R1/4 Mass: 1650g (Plug), 2800g (Socket)

Plug: Model **MAM-A-2P12**

Socket: Model **MAM-A-2S12**

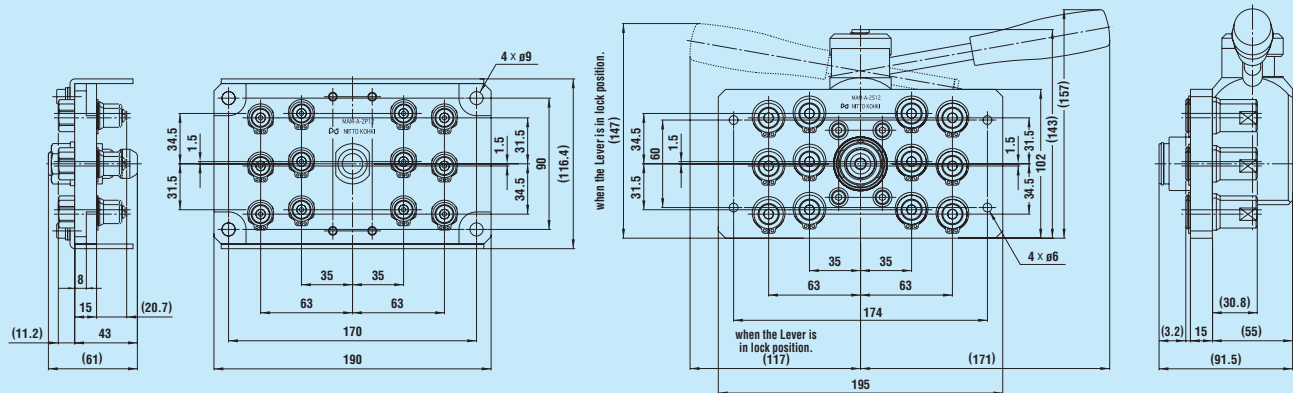

Dimensions (mm)

Plug Model **MAM-A-2P** (Cupla only)

• Application: R1/4 Mass: 40g

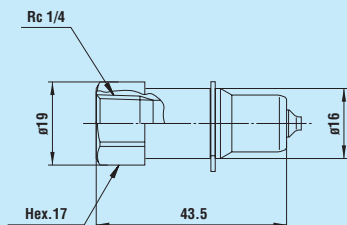

Dimensions (mm)

Socket Model **MAM-A-2S** (Cupla only)

• Application: R1/4 Mass: 82g

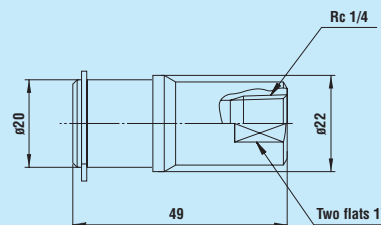

Dimensions (mm)

Made-to-order Multi Couplas are available on request, such as a combination of different sizes on the flange plate.

**Models and Dimensions**

**Model MAM-A-3P6 × MAM-A-3S6 (6 ports on smaller plate)**

• Application: R3/8 Mass: 1250g (Plug), 2400g (Socket)

Plug: Model **MAM-A-3P6**

Socket: Model **MAM-A-3S6**

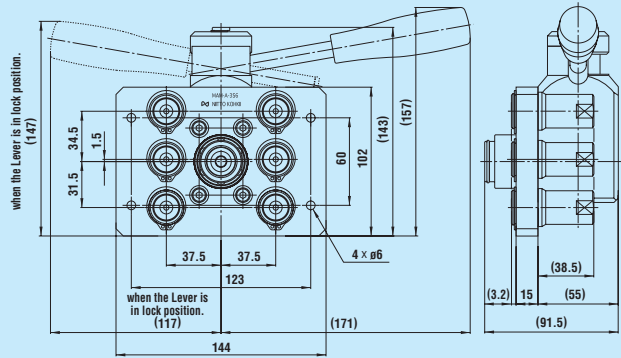
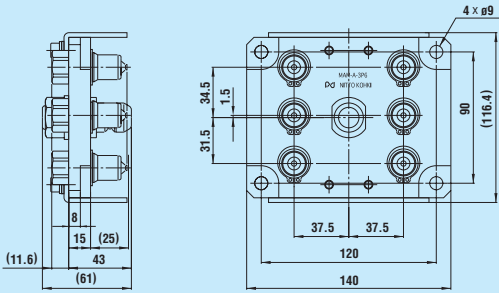

Dimensions (mm)

**Model MAM-A-3P12 × MAM-A-3S12 (12 ports on larger plate)**

• Application: R3/8 Mass: 1950g (Plug), 3300g (Socket)

Plug: Model **MAM-A-3P12**

Socket: Model **MAM-A-3S12**

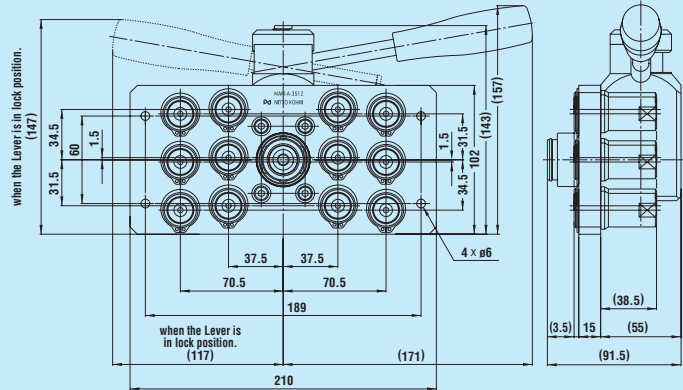
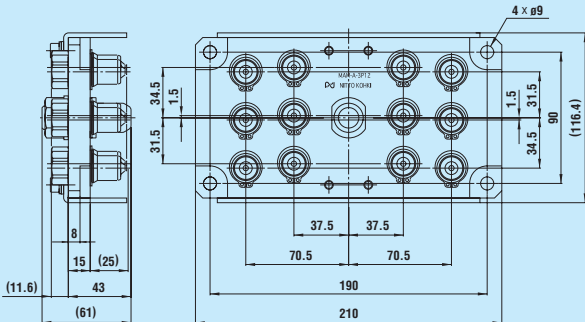

Dimensions (mm)

**Plug Model MAM-A-3P (Cupla only)**

• Application: R3/8 Mass: 62g

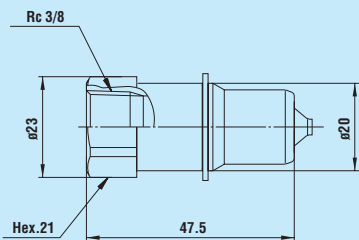

Dimensions (mm)

**Socket Model MAM-A-3S (Cupla only)**

• Application: R3/8 Mass: 122g

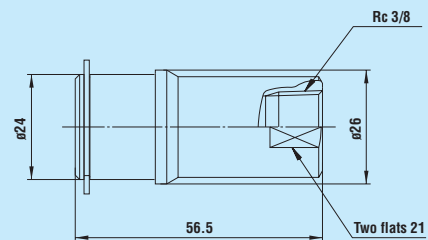

Dimensions (mm)

Made-to-order Multi Cuplas are available on request, such as a combination of different sizes on the flange plate.

Models and Dimensions

Model **MAM-A-4P4 × MAM-A-4S4** (4 ports on smaller plate)

• Application: R1/2 Mass: 1400g (Plug), 2700g (Socket)

Plug: Model **MAM-A-4P4**

Socket: Model **MAM-A-4S4**

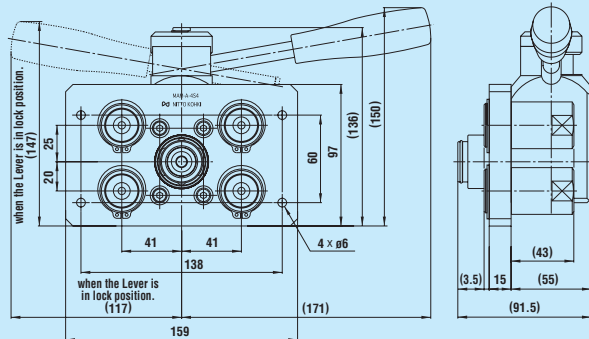
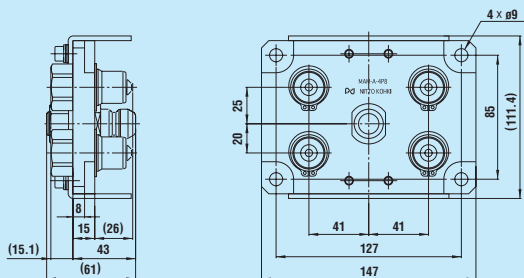

Dimensions (mm)

Model **MAM-A-4P8 × MAM-A-4S8** (8 ports on larger plate)

• Application: R1/2 Mass: 2300g (Plug), 4000g (Socket)

Plug: Model **MAM-A-4P8**

Socket: Model **MAM-A-4S8**

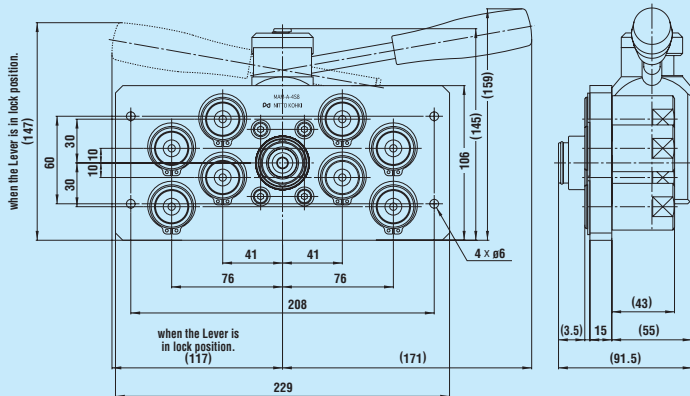
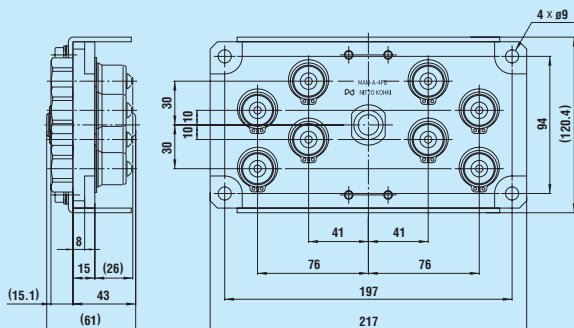

Dimensions (mm)

Plug Model **MAM-A-4P** (Cupla only)

• Application: R1/2 Mass: 127g

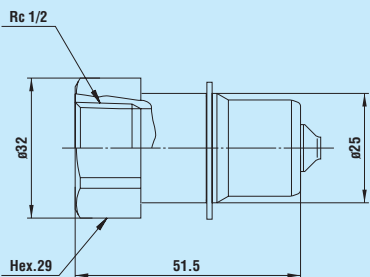

Dimensions (mm)

Socket Model **MAM-A-4S** (Cupla only)

• Application: R1/2 Mass: 256g

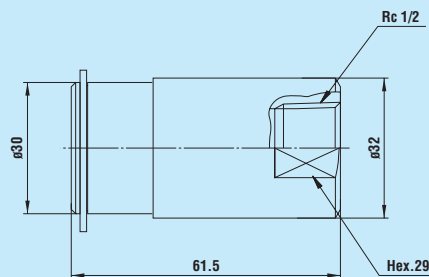

Dimensions (mm)