

For Gases and Liquids

Lever Lock Cupla

Metal body / Plastic body

For bulk flow, low pressure applications

Working pressure **1.8** 1.8 MPa (18 kgf/cm²)

Working pressure **0.5** 0.5 MPa (5 kgf/cm²)

Valve structure Straight through

Designs and specifications are subject to change for improvement without notice

Applicable fluids (plastic body Cuplas are for water or air only)

Water Hydraulic oil Steam Air

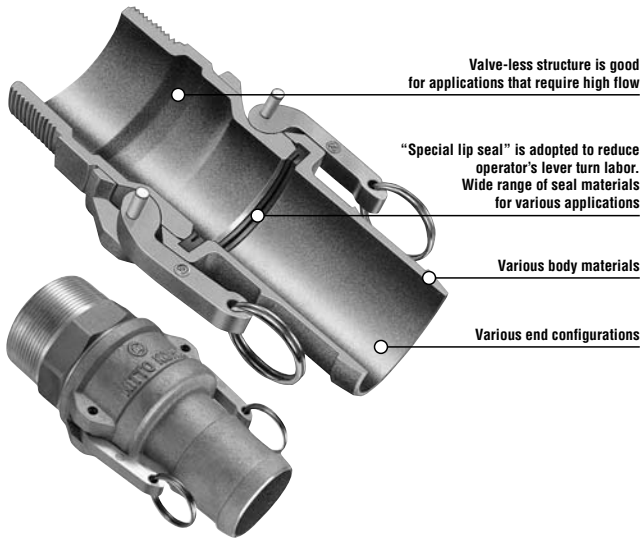

Light lever pull-down will connect the plug and socket without fail ready to flow liquid, or gases.

- This Cupla complies with diversified applications in liquid or gas transportation.
- End seal structure enables no bumps or hollows on the internal fluid passage, and ensures smooth fluid transportation.
- "Special lip seal" adopted (except 3/4", 1" sizes and silicon rubber seal) for light lever action and tight and sure sealing when connected.
- Connection part dimensions comply with US military specifications MIL-A-A-59326.
- The variety of body materials, sizes and end configurations has been standardized to comply with wide range of applications.
- Additional stopper function design will enhance safety (made-to-order product).

Specifications (Metal body)							
Body material (Material symbol)	Aluminum alloy (AL), Copper alloy (BR)			Stainless Steel (SUS)			
Size	3/4"~2"	2 1/2"	3"	4"	3/4"~2"	2 1/2"~3"	4"
Working pressure MPa (kgf/cm ²)	1.8 (18)	1.1 (11)	0.9 (9)	0.7 (7)	1.8 (18)	1.6 (16)	1.1 (11)
Pressure resistance MPa (kgf/cm ²)	2.7 (27)	1.7 (17)	1.4 (14)	1.1 (11)	2.7 (27)	2.4 (24)	1.7 (17)
Seal material/Working temperature range	Seal material : Nitrile rubber / Mark.NBR (SG) / Working temperature range : -20°C~+80°C						
Optional seal material Working temperature range	Seal material	Mark		Working temperature range			
	Silicone rubber	SI		-40°C~+150°C			
	Fluoro rubber	FKM (X-100)		-20°C~+180°C			
	Ethylene-propylene rubber	EPDM (EPT)		-40°C~+150°C			
	FEP-covered silicon rubber*	—		+5°C~+50°C			

*Made-to-order (itemWorking pressure : 0.2MPa (2kgf/cm²) / Pressure resistance : 0.3MPa (3kgf/cm²))

Specifications (Plastic body)				
Body material (Material symbol)	Polypropylene (PP)			
Size	3/4" • 1" • 1 1/2"		2" • 3"	
Working pressure* MPa (kgf/cm ²)	0.5 (5)		0.2 (2)	
Pressure resistance* MPa (kgf/cm ²)	0.7 (7)		0.35 (3.5)	
Seal material/Working temperature range	Seal material : Nitrile rubber / Mark.NBR (SG) / Working temperature range : +5°C~+50°C			
Optional seal material Working temperature range	Seal material	Mark		Working temperature range
	Silicone rubber	SI		+5°C~+50°C
	Fluoro rubber	FKM (X-100)		+5°C~+50°C
	Ethylene-propylene rubber	EPDM (EPT)		+5°C~+50°C

*Made-to-order (itemWorking pressure : 0.2MPa (2kgf/cm²) / Pressure resistance : 0.3MPa (3kgf/cm²))

Max. Tightening Torque		N-m (kgf-cm)							
Size		3/4"	1"	1 1/4"	1 1/2"	2"	2 1/2"	3"	4"
Torque	Aluminum alloy	50 (510)	70 (714)	120 (1224)	140 (1428)	260 (2652)	350 (3570)	410 (4182)	470 (4794)
	Copper alloy								
	Stainless alloy	90 (918)	120 (1224)	220 (2244)	260 (2652)	350 (3570)	480 (4896)	520 (5304)	590 (6018)

Flow Direction

Fluid may flow in either direction from plug or from socket side when coupled.

Interchangeability

Same size sockets and plugs are interchangeable regardless of their end configurations. Connection part dimensions are in compliance with MIL-A-A-59326.

Suitability for Vacuum (Metal body)		53.0kPa (400mmHg)
Socket only	Plug only	When connected
—	—	Operational

Suitability for Vacuum (Plastic body)

Not suitable for vacuum application in either connected or disconnected condition.

Dimensions with lever fully opened		
Metal (This drawing is for LC Type.)		
	Size	Dimensions E (mm)
	3/4"	122
	1"	132
	1 1/4"	183
	1 1/2"	191
	2"	201
	2 1/2"	213
	3"	250
4"	278	
Plastic (This drawing is for LC Type.)		
	Size	Dimensions E (mm)
	3/4"	111
	1"	126
	1 1/2"	185
	3"	249

Models and Dimensions

Dimensions of products may differ according to body material. / WAF : WAF stands for width across flats.

Plug LE type (Hose barb)

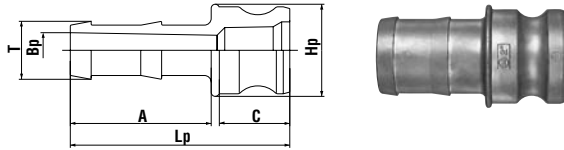

material	Model	Size	Mass (g)	Dimensions (mm)						
				Lp	A	C	øHp	øT	øBp	
Aluminum alloy	LE-6TPH	3/4"	65	81	52	26	34	21.5	11	
	LE-8TPH	1"	100	95	58	34	40	27.5	17.5	
	LE-10TPH	1 1/4"	140	102	58	40	48	34	23.5	
	LE-12TPH	1 1/2"	190	107	61	42	58	40.5	29.5	
	LE-16TPH	2"	290	122	70	48	69	53	40	
	LE-20TPH	2 1/2"	390	134.5	80	50	81	67	50	
Copper alloy	LE-24TPH	3"	545	167	101	61.5	97	79	68	
	LE-32TPH	4"	850	176	106	63.5	133	105	93	
	LE-6TPH	3/4"	215	90.5	52.5	26	39	21.5	12.5	
	LE-8TPH	1"	305	107	60	34.5	41	27.5	20	
	LE-10TPH	1 1/4"	440	102	58	40	48	34	25.5	
	LE-12TPH	1 1/2"	560	107	61	42	58	40.5	31.5	
Stainless steel	LE-16TPH	2"	865	131	73	54	70.5	53.5	44.5	
	LE-20TPH	2 1/2"	1180	149	84	48	91	67	57	
	LE-24TPH	3"	1800	171	104	50	102	79.4	70	
	LE-32TPH	4"	3500	176	109	57	129	105	93	
	LE-6TPH	3/4"	170	90	52	35.5	35	21	15	
	LE-8TPH	1"	265	107	60	44	42	27	20	
LE-10TPH	1 1/4"	430	111	61	40	45	34	25.5		
LE-12TPH	1 1/2"	530	114	61	40	60	40	33		
LE-16TPH	2"	790	131	73	45	70	53	44		
LE-20TPH	2 1/2"	1195	149	84	48	91	67	57		
LE-24TPH	3"	1755	162	99.5	56.5	102	78	68		
LE-32TPH	4"	2595	174	109	59	130	105	94		

Socket LC type (Hose barb)

Model LC-6TSH has no rings.

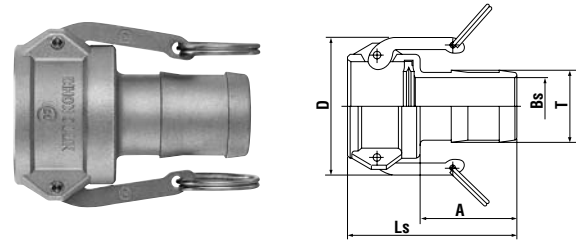

material	Model	Size	Mass (g)	Dimensions (mm)				
				Ls	A	D	øT	øBs
Aluminum alloy	LC-6TSH	3/4"	140	85	52	60.5	21.5	11
	LC-8TSH	1"	190	99	58	61	27.5	17
	LC-10TSH	1 1/4"	320	104	58	82	34	23
	LC-12TSH	1 1/2"	350	108.5	61	90	40.5	29
	LC-16TSH	2"	430	122.5	70	100	53	41.5
	LC-20TSH	2 1/2"	560	136.5	80	112	66.5	54
Copper alloy	LC-24TSH	3"	915	175	100	139	79	68
	LC-32TSH	4"	1190	180	104	165	104	93
	LC-6TSH	3/4"	320	85	52	61.5	21.5	13
	LC-8TSH	1"	420	99	58	61	27.5	19.5
	LC-10TSH	1 1/4"	700	104	58	82	34	25.5
	LC-12TSH	1 1/2"	720	110	62	91	41	33
Stainless steel	LC-16TSH	2"	870	121	70	100	53	44
	LC-20TSH	2 1/2"	1530	137	83	113	67	57
	LC-24TSH	3"	1795	160	105	139	79	68
	LC-32TSH	4"	3100	163	107	168	104	92
	LC-6TSH	3/4"	230	86	52	55	21	15
	LC-8TSH	1"	340	99	60	63	27	20
LC-10TSH	1 1/4"	615	107	61	85	34	25.5	
LC-12TSH	1 1/2"	645	108	61	91	40	33	
LC-16TSH	2"	1000	129	73	101	53	44	
LC-20TSH	2 1/2"	1270	134	81	113	67	57	
LC-24TSH	3"	2065	158	100	139	79	67	
LC-32TSH	4"	3020	165	107	167	105	94	

Plug LA type (Female thread)

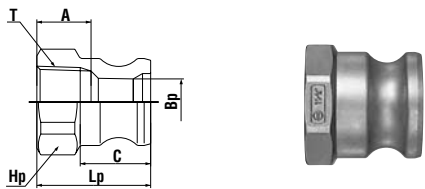

material	Model	Size	Mass (g)	Dimensions (mm)						
				Lp	A	C	Hp(WAF)	øBp	T	
Aluminum alloy	LA-6TPF	3/4"	45	42	20	26	Hex.36	17	Rc 3/4	
	LA-8TPF	1"	65	52	24	34	Hex.41	22.5	Rc 1	
	LA-10TPF	1 1/4"	110	59	28	40	Hex.50	27.5	Rc1 1/4	
	LA-12TPF	1 1/2"	130	58	24	42	Hex.60	34.5	Rc1 1/2	
	LA-16TPF	2"	170	63.5	28	48	Oct.70	44.5	Rc 2	
	LA-20TPF	2 1/2"	320	85	32	50	Oct.85	55.5	Rc2 1/2	
Copper alloy	LA-24TPF	3"	370	79	28	52.5	Dod.99	73.5	Rc 3	
	LA-32TPF	4"	640	82	40	54	Dod.130	100	Rc 4	
	LA-6TPF	3/4"	145	42	16	27	Oct.34	20	Rc 3/4	
	LA-8TPF	1"	190	46	22	32	Oct.41	24	Rc 1	
	LA-10TPF	1 1/4"	390	59	26	40	Hex.50	28	Rc1 1/4	
	LA-12TPF	1 1/2"	420	58	24	42	Hex.60	36	Rc1 1/2	
Stainless steel	LA-16TPF	2"	560	63.5	27	48	Oct.70	45	Rc 2	
	LA-20TPF	2 1/2"	950	79	28	50	Dod.84	56	Rc2 1/2	
	LA-24TPF	3"	1210	71	30	50	Dod.101	70	Rc 3	
	LA-32TPF	4"	1620	79	37	53	Dod.127	101	Rc 4	
	LA-6TPF	3/4"	120	39	19	27	Oct.33	19	Rc 3/4	
	LA-8TPF	1"	170	47	21	33	Oct.41	24	Rc 1	
LA-10TPF	1 1/4"	270	53.5	23	41	Oct.50	28	Rc1 1/4		
LA-12TPF	1 1/2"	375	55	23	40	Oct.58	35.5	Rc1 1/2		
LA-16TPF	2"	505	62	25	47	Oct.69	45	Rc 2		
LA-20TPF	2 1/2"	825	77	28	49	Dod.83	56	Rc2 1/2		
LA-24TPF	3"	875	72	31.5	51	Dod.96	73	Rc 3		
LA-32TPF	4"	1470	79	36	53	Dod.124	100	Rc 4		

Socket LD type (Female thread)

Model LD-6TSF has no rings.

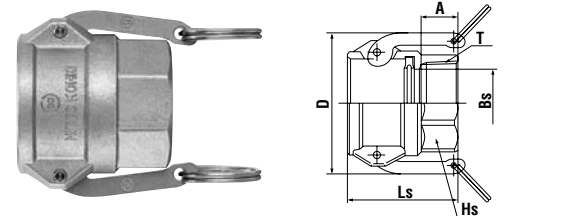

material	Model	Size	Mass (g)	Dimensions (mm)						
				Ls	A	D	Hs(WAF)	øBs	T	
Aluminum alloy	LD-6TSF	3/4"	130	53	20	60.5	Hex.36	21	Rc 3/4	
	LD-8TSF	1"	190	64.5	24	61	Hex.41	26	Rc 1	
	LD-10TSF	1 1/4"	330	72.5	26	82	Hex.50	34	Rc1 1/4	
	LD-12TSF	1 1/2"	360	70.5	24	90	Hex.60	39	Rc1 1/2	
	LD-16TSF	2"	420	79.5	27	100	Oct.70	49	Rc 2	
	LD-20TSF	2 1/2"	550	88.5	32	112	Oct.85	59	Rc2 1/2	
Copper alloy	LD-24TSF	3"	800	89	32	140	Dod.99	75	Rc 3	
	LD-32TSF	4"	1140	93	35	165	Dod.131	94	Rc 4	
	LD-6TSF	3/4"	310	53	20	60.5	Hex.36	21	Rc 3/4	
	LD-8TSF	1"	430	64.5	24	61	Hex.41	26	Rc 1	
	LD-10TSF	1 1/4"	730	72.5	26	82	Hex.50	34	Rc1 1/4	
	LD-12TSF	1 1/2"	770	70.5	24	90	Oct.60	39	Rc1 1/2	
Stainless steel	LD-16TSF	2"	990	79.5	27	100	Oct.70	49	Rc 2	
	LD-20TSF	2 1/2"	1290	81.5	28	113	Dod.84	61	Rc2 1/2	
	LD-24TSF	3"	1560	88	31	139	Dod.98	76	Rc 3	
	LD-32TSF	4"	3590	91	29.5	167	Dod.126	96	Rc 4	
	LD-6TSF	3/4"	225	52	18	55	Oct.32	19	Rc 3/4	
	LD-8TSF	1"	350	60	20	63	Oct.41	24	Rc 1	
LD-10TSF	1 1/4"	600	68	23	85	Oct.50	30	Rc1 1/4		
LD-12TSF	1 1/2"	715	72	24	87	Oct.58	37.5	Rc1 1/2		
LD-16TSF	2"	940	78.5	25	100	Oct.69	50	Rc 2		
LD-20TSF	2 1/2"	1050	82	29	113	Dod.83	61	Rc2 1/2		
LD-24TSF	3"	1605	88	31.5	139	Dod.96	75	Rc 3		
LD-32TSF	4"	2575	94	37	167	Dod.125	97	Rc 4		

Before use, please be sure to read "Safety Guide" described at the end of this book and "Instruction Sheet" that comes with the products.

Models and Dimensions

Dimensions of products may differ according to body material. / WAF : WAF stands for width across flats.

Plug LF type (Male thread)

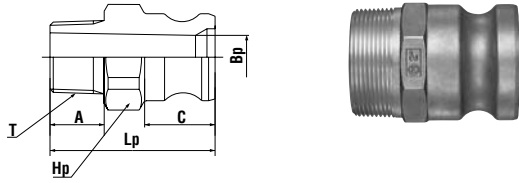

material	Model	Size	Mass (g)	Dimensions (mm)					
				Lp	A	C	Hp(WAF)	øBp	T
Aluminum alloy	LF-6TPM	3/4"	70	61	20	26	Hex.36	16	R 3/4
	LF-8TPM	1"	90	73	24	34	Hex.41	22	R 1
	LF-10TPM	1 1/4"	140	81	26	40	Hex.50	28	R1 1/4
	LF-12TPM	1 1/2"	150	80.5	24	42	Oct.55	34.5	R1 1/2
	LF-16TPM	2"	220	89.5	27	48	Oct.65	44.5	R 2
	LF-20TPM	2 1/2"	370	101	32	50	Oct.80	56	R2 1/2
	LF-24TPM	3"	470	106	31	52	Dod.99	73	R 3
	LF-32TPM	4"	875	116	34	54	Dod.130	100	R 4
	Copper alloy	LF-6TPM	3/4"	185	59	20	27	Hex.34	20
LF-8TPM		1"	280	69	21.5	32	Hex.41	24	R 1
LF-10TPM		1 1/4"	460	81	26	40	Hex.50	28	R1 1/4
LF-12TPM		1 1/2"	500	81	24	42	Oct.55	36	R1 1/2
LF-16TPM		2"	750	89.5	27	48	Oct.65	45	R 2
LF-20TPM		2 1/2"	1290	98	28	50	Dod.83	56	R2 1/2
LF-24TPM		3"	1480	103	30	50.8	Dod.96	73	R 3
LF-32TPM		4"	3155	113	35	53	Dod.126	100	R 4
Stainless steel		LF-6TPM	3/4"	175	59	19	27	Oct.33	19
	LF-8TPM	1"	255	69	21	33	Oct.41	24	R 1
	LF-10TPM	1 1/4"	415	80	24	42	Oct.50	29.5	R1 1/4
	LF-12TPM	1 1/2"	575	80	24	40	Oct.58	36.5	R1 1/2
	LF-16TPM	2"	735	87	24	47	Oct.69	46	R 2
	LF-20TPM	2 1/2"	1020	99	28	49	Dod.83	56	R2 1/2
	LF-24TPM	3"	1415	103	30.5	51	Dod.96	73	R 3
	LF-32TPM	4"	2275	112	33	53	Dod.124	100	R 4

Socket LB type (Male thread)

Body materials other than aluminum alloy are made-to-order items.

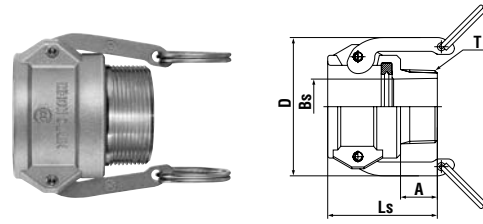

material	Model	Size	Mass (g)	Dimensions (mm)				
				Ls	A	D	øBs	T
Aluminum alloy	LB-6TSM	3/4"	110	53	20	60.5	17	R 3/4
	LB-8TSM	1"	170	65	24	61	23.5	R 1
	LB-10TSM	1 1/4"	310	72	26	82	29.5	R1 1/4
	LB-12TSM	1 1/2"	340	71.5	24	90	36	R1 1/2
	LB-16TSM	2"	400	79.5	27	100	46	R 2
	LB-20TSM	2 1/2"	530	88.5	32	112	57.5	R2 1/2
	LB-24TSM	3"	715	90	31	139	76	R 3
	LB-32TSM	4"	920	92	33.5	165	99	R 4
	Copper alloy (Made-to-order item)	LB-6TSM	3/4"	260	52	18	53	19.5
LB-8TSM		1"	355	63	22	62	26	R 1
LB-10TSM		1 1/4"	620	71	24	84	28	R1 1/4
LB-12TSM		1 1/2"	700	71	25	91	36	R1 1/2
LB-16TSM		2"	950	81	24	100	51	R 2
LB-20TSM		2 1/2"	1250	86	32	113	63	R2 1/2
LB-24TSM		3"	1780	92	33	139	78	R 3
LB-32TSM		4"	2540	98	40	168	101	R 4
Stainless steel (Made-to-order item)		LB-6TSM	3/4"	210	52.5	19	55	20
	LB-8TSM	1"	300	63	23.5	63	25.5	R 1
	LB-10TSM	1 1/4"	520	70.5	24.5	85	34	R1 1/4
	LB-12TSM	1 1/2"	580	71.5	24	87	38	R1 1/2
	LB-16TSM	2"	780	78.5	24	101	50.5	R 2
	LB-20TSM	2 1/2"	980	84	31	113	66	R2 1/2
	LB-24TSM	3"	1490	92	32	139	78.5	R 3
	LB-32TSM	4"	2080	92	34.5	167	92	R 4

Plug L-PD type (Plug cap)

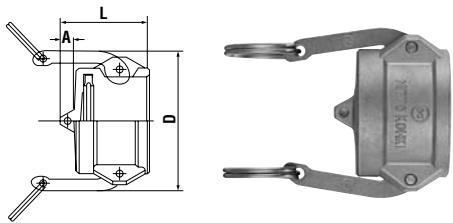

material	Model	Size	Mass (g)	Dimensions (mm)		
				L	A	D
Aluminum alloy	L-6PD	3/4"	100	46	12	54
	L-8PD	1"	145	54	12	62
	L-10PD	1 1/4"	230	60	13	83
	L-12PD	1 1/2"	295	68	17	91
	L-16PD	2"	360	68	11	100
	L-20PD	2 1/2"	435	72	15	113
	L-24PD	3"	690	72	10	139
	L-32PD	4"	870	76	15	167
	Copper alloy	L-6PD*	3/4"	220	45	11
L-8PD*		1"	315	53	12	62
L-10PD		1 1/4"	610	57	11	84
L-12PD		1 1/2"	645	69	17.5	91
L-16PD		2"	830	68	11	100
L-20PD		2 1/2"	980	71	14	113
L-24PD		3"	1380	81	20	139
L-32PD		4"	2700	90	26	168
Stainless steel		L-6PD	3/4"	180	45	12
	L-8PD	1"	265	52	11	63
	L-10PD	1 1/4"	475	60	12	85
	L-12PD	1 1/2"	545	63	15	87
	L-16PD	2"	720	65	11	101
	L-20PD	2 1/2"	945	71	15	113
	L-24PD	3"	1420	72	12	139
	L-32PD	4"	2055	77	14	167

Socket L-SD type (Socket cap)

* No ring hole.

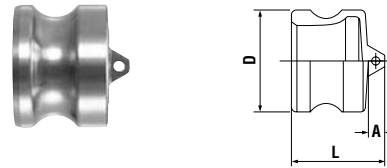

material	Model	Size	Mass (g)	Dimensions (mm)		
				L	A	øD
Aluminum alloy	L-6SD*	3/4"	35	32	8	32
	L-8SD*	1"	45	44	10	36.7
	L-10SD	1 1/4"	70	57	14	45.5
	L-12SD	1 1/2"	90	54	15	53.4
	L-16SD	2"	140	62	13	63
	L-20SD	2 1/2"	210	69	20	75.8
	L-24SD	3"	290	71	15	91.5
	L-32SD	4"	960	74	16	119.4
	Copper alloy	L-6SD	3/4"	160	34	8
L-8SD		1"	150	44	10	36.7
L-10SD		1 1/4"	210	55	12	45.5
L-12SD		1 1/2"	290	54	15	54
L-16SD		2"	420	61	12	63
L-20SD		2 1/2"	630	69	19	77
L-24SD		3"	860	71	15	91.5
L-32SD		4"	1780	74.5	16	119.5
Stainless steel		L-6SD	3/4"	95	39	12
	L-8SD	1"	145	45	12	37
	L-10SD	1 1/4"	250	51	10	45
	L-12SD	1 1/2"	300	54	14	53
	L-16SD	2"	490	58	11	63
	L-20SD	2 1/2"	710	64	14	76
	L-24SD	3"	930	68	14	92
	L-32SD	4"	1275	68	14	120

Models and Dimensions

Plug LE type (Hose barb)

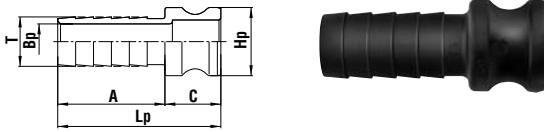

material	Model	Size	Mass (g)	Dimensions (mm)					
				Lp	A	C	øHp	øT	øBp
Plastic	LE-6TPH	3/4"	16	74.5	51.5	23	32	21	14.5
	LE-8TPH	1"	29	87.5	57.5	30	36.5	26.5	19
	LE-12TPH	1 1/2"	73	103	61	42	54	40	30
	LE-16TPH	2"	122	119	71	48	63	53	41
	LE-24TPH	3"	221	152.5	108	44.5	91	80	65

Socket LC type (Hose barb)

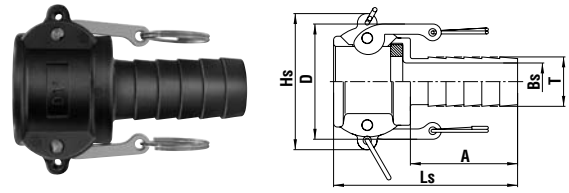

material	Model	Size	Mass (g)	Dimensions (mm)					
				Ls	A	D	Hs	øT	øBs
Plastic	LC-6TSH	3/4"	64	83.5	52	65.5	52	20	14
	LC-8TSH	1"	104	99	57.5	62	73	26.5	20
	LC-12TSH	1 1/2"	242	111	61	91	101	40	30
	LC-16TSH	2"	269	126	71	100	106	51	41
	LC-24TSH	3"	527	161	102	136	138	77.5	65

Plug LA type (Female thread)



material	Model	Size	Mass (g)	Dimensions (mm)					
				Lp	A	C	Hp(WAF)	øBp	T
Plastic	LA-6TPF	3/4"	19	42	16	26	Hex.34	21	Rc 3/4
	LA-8TPF	1"	27	59	25	34	Hex.43	22	Rc 1
	LA-12TPF	1 1/2"	65	67	25	42	Ribbed 65	37	Rc1 1/2
	LA-16TPF	2"	90	72.5	25	48.5	Ribbed 74	44	Rc 2
	LA-24TPF	3"	211	90	33.5	52.5	Ribbed 108	72	Rc 3

Socket LD type (Female thread)

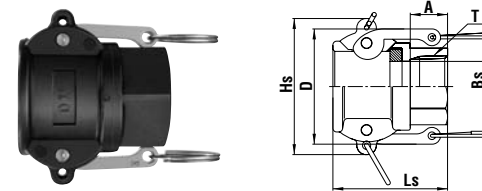

material	Model	Size	Mass (g)	Dimensions (mm)					
				Ls	A	D	Hs(WAF)	øBs	T
Plastic	LD-6TSF	3/4"	65	50	19	58	Hex.32	20	Rc 3/4
	LD-8TSF	1"	98	61.5	20	62	Hex.41	27	Rc 1
	LD-12TSF	1 1/2"	260	78	29.5	92	Ribbed 68	39	Rc1 1/2
	LD-16TSF	2"	285	84	29.5	101	Ribbed 80	50	Rc 2
	LD-24TSF	3"	444	88.5	33	138	Ribbed 109	75	Rc 3

Plug LF type (Male thread)

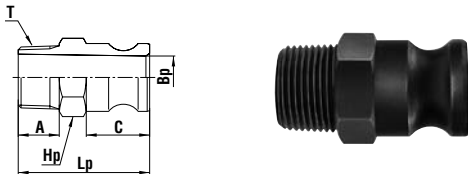

material	Model	Size	Mass (g)	Dimensions (mm)					
				Lp	A	C	Hp(WAF)	øBp	T
Plastic	LF-6TPM	3/4"	23	60	20	26	Hex.32	19	R 3/4
	LF-8TPM	1"	19	70.5	22	34	Hex.37	23	R 1
	LF-12TPM	1 1/2"	72	77	22	42	Ribbed 63	32	R1 1/2
	LF-16TPM	2"	105	84.5	24.5	48	Ribbed 74	45	R 2
	LF-24TPM	3"	210	102	32	51	Ribbed 100	72	R 3

Socket LB type (Male thread)

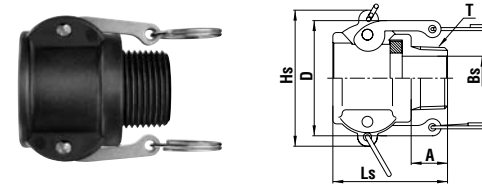

material	Model	Size	Mass (g)	Dimensions (mm)					
				Ls	A	D	Hs	øBs	T
Plastic	LB-6TSM	3/4"	58	51	19	65.5	52	19	R 3/4
	LB-8TSM	1"	88	61.5	19.5	62	61	23.5	R 1
	LB-12TSM	1 1/2"	227	75	25	91	101	37.5	R1 1/2
	LB-16TSM	2"	251	84	28.5	101	108	48.5	R 2
	LB-24TSM	3"	397	91	31.5	136	122	75	R 3

Plug L-PD type (Plug cap)

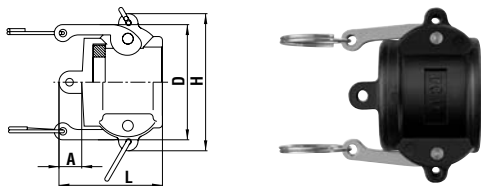

material	Model	Size	Mass (g)	Dimensions (mm)			
				L	A	D	H
Plastic	L-6PD	3/4"	60	45	12	65.5	52
	L-8PD	1"	94	55.5	12	62	73.5
	L-12PD	1 1/2"	214	65	15	91	101
	L-16PD	2"	219	69	14	100	106
	L-24PD	3"	408	77	17.5	136	138

Socket L-SD type (Socket cap)



material	Model	Size	Mass (g)	Dimensions (mm)		
				L	A	øD
Plastic	L-6SD	3/4"	10	35.5	11	32
	L-8SD	1"	18	42	11	36.5
	L-12SD	1 1/2"	46	53.5	14	53
	L-16SD	2"	68	62	14	63
	L-24SD	3"	102	65	18	91

Stopper installation (for plastic only)

Equipped with lever stopper pin tabs to prevent unintended disconnection (for selected models only).

