

# delvo

## Parts List

Model  
**DLR5340-WU**



**NITTO KOHKI**

Manufactured by:

**NITTO KOHKI CO., LTD.**

9-4, NAKAIKEGAMI 2-CHOME, OHTA-KU,  
TOKYO 146-8555, JAPAN

Tel : +81-3-3755-1111

Fax : +81-3-3753-8791

Repair Parts List for DLR5340-WU

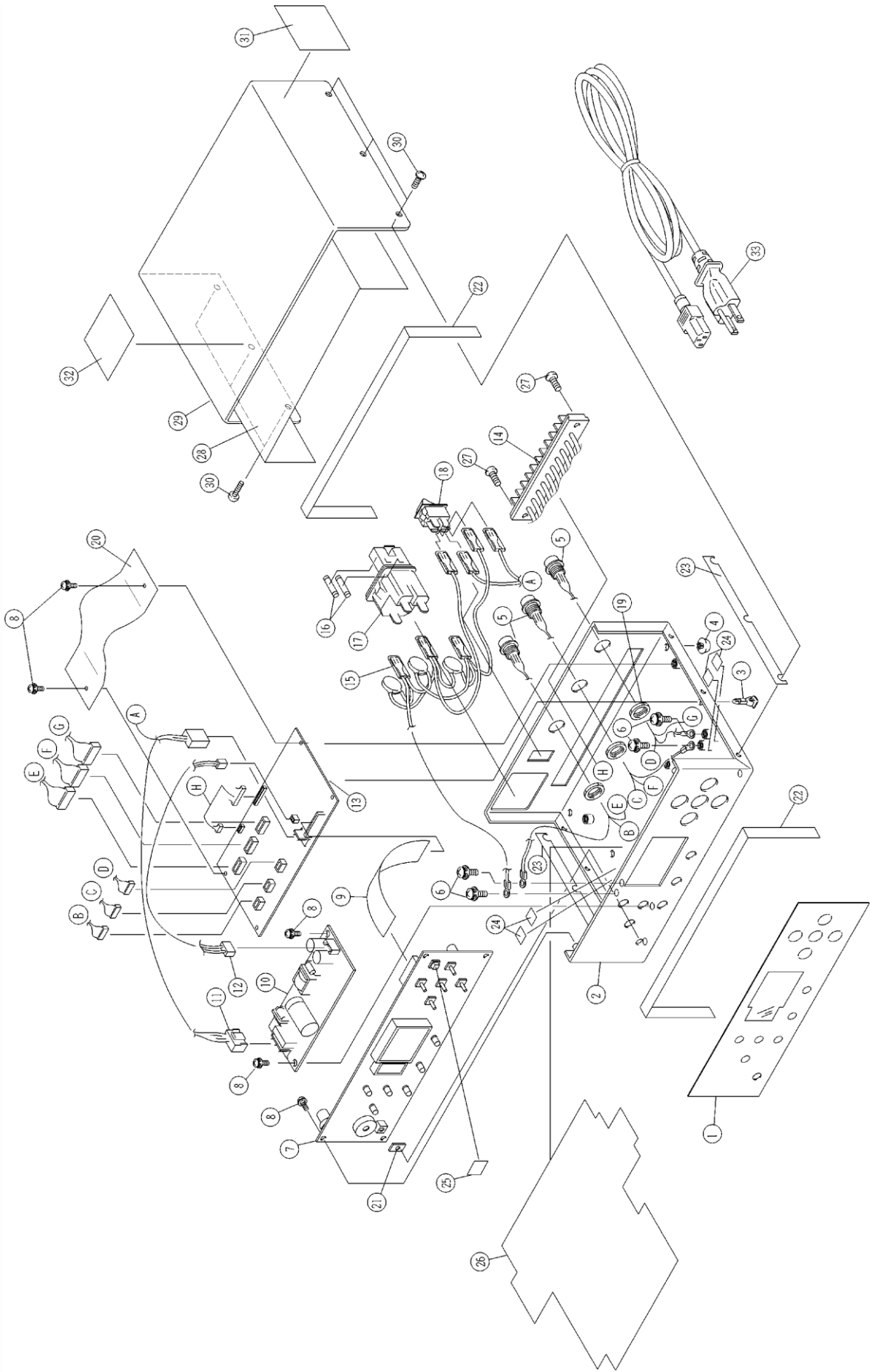

## List of DLR5340-WU

No.	Parts Name	Parts No.	Q'ty
1	Face Label	TV07080	1
2	Chassis	TD07856	1
3	Spacer	TV02516	2
4	Rubber Foot	TV03202	4
5	Receptacle Assembly	TD07853	3
6	Screw M4x8L (with washer)	TV02407	4
7	Control Base Assembly	TD05212	1
8	Screw M3x6L (with washer)	TV04112	8
9	Flat Cable	TV05186	1
10	Power Supply	TV04107	1
11	Wire Assembly	TD07854	1
12	Wire Assembly	TD03901	1
13	Control Base Assembly	TD07855	1
14	Terminal Block Assembly	TD07820	1
15	Surge Absorber Assembly	TD06570	1
16	Fuse	TV02160	2
17	Inlet	TV04108	1

18	Power Switch	TV04109	1
19	Nut	TV07013	3
20	Insulated plate C	TV07075	1
21	Packing C	TV07079	1
22	Packing A	TV07077	2
23	Packing B	TV07078	2
24	Earth Label	TV01857	4
25	Insulated Plate A	TV05374	1
26	Insulated Plate B	TV07074	1
27	Tapping Screw M3x10L	TP17217	2
28	Insulated Plate D	TV07076	1
29	Cover	TV07073	1
30	Screw M3x5L	TV04178	6
31	Rating Label		1
32	Warning Label		1
33	Power Cord Assembly	TD02957	1